

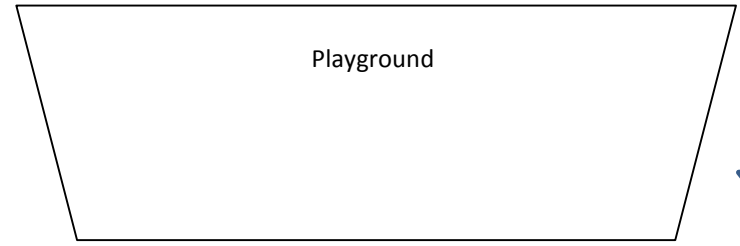

Jonas Salk Elementary
 7825 Flanders
 San Diego, CA 92126
 (858) 935-2100



Downstairs

Upstairs

Upstairs

Downstairs



PE ROOM 300
2 nd grade 301
2 nd grade 302
2 nd grade 303
2 nd grade 304

Room 400
Room 401
Room 402
Room 403
Room 404

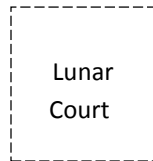

3 rd grade 200
3 rd grade 201
3 rd grade 202
3 rd grade 203

1 st grade 100
1 st grade 101
1 st grade 102
1 st grade 103

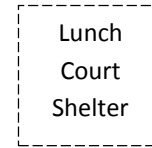

Lunch Court

Kitchen	Supply Room
Multi-Purpose Room	

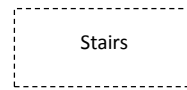
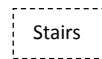
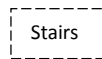
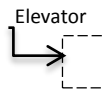

FLANDERS "Sigmoid Gate"

Upstairs

Downstairs

4 th /5 th grade 600	4 th grade 601	SE/SCI LAB 4 th grade 602	SE/SCI LAB 5 th grade 603	5 th grade 604	4 th /5 th grade 605
Champions Day Care Am/Pm 500	Blended ECSE 501	KINDER 502	KINDER 503	KINDER 504	KINDER 505

PRE-SCHOOL ENTRANCE

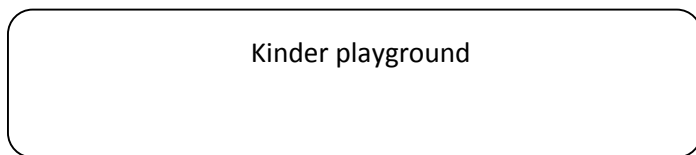

700
701

Media Center
Resources
Parent Room

LOBBY
Front office
Nurse

"PARKDALE GATE"

Left turn ONLY

