



Mira Mesa HIGH SCHOOL

Marauder Mask

A publication of news and upcoming events.

Volume 9, Issue 1

August 27, 2021

Principal-Jeff Sabins
Editor/Publisher-Amanda Courtney

Principal's Message:

We are so excited to welcome you all back to campus on Monday, August 30th. We have been working hard to prepare the campus to ensure your high school experience will be both memorable and safe. I wanted to go over a few important things ahead of Monday.

I recorded a special edition of the M5 for you, viewable here: <https://youtu.be/DM9kQASBhQ4>

1. Masks: As you have heard, masks are required at all times while on campus. Individuals may remove masks, while outdoors and distanced from others, when actively eating/drinking or taking a brief "mask break".
2. Bell Schedule: Monday is a "Regular Day", with school starting at 8:35AM and ending at 3:30PM. (The "Marauder Minutes" bell schedule is included in this edition of the MASK.
3. Student Schedules: Official Schedules will be viewable in the PowerSchool Student Portal on Saturday morning. Students should login to PowerSchool Student Portal to familiarize themselves with their schedule in preparation of Monday. (Paper schedules will be available in the Quad on Monday morning for students unable to access the schedule digitally.)
4. [Back to School Guide](#): SDUSD has created and released a helpful "Back to School Guide" to help students and families prepare for the 21-22 school year. Be sure to check it out!
5. PowerSchool Parent Portal: It is important that all parents/guardians have access to a PowerSchool Parent Portal account. If you need access, please email Shirley Lemmon at slemmon@sandi.net to gain access.
6. Football Game (8/27): Tonight, our Marauders host San Marcos for a football double header. The Sapphire Sound will be providing amazing entertainment and the sideline cheerleaders will be out in full force. Masks are required in the stadium. Tickets are available [digitally](#) or at the gate.

Happy Weekend!
Principal Sabins

Helpful Links:

MMHS WEBSITE:

<https://miramesa.sandiegounified.org>

MMHS ATHLETICS:

<https://mymarauders.com/>

POWERSCHOOL STUDENT/PARENT PORTAL:

<https://powerschool.sandi.net/public/>

TECHNOLOGY SUPPORT FOR FAMILIES:

<https://sites.google.com/sandi.net/instructionalcontinuityit/technology-support-for-families>

SDUSD BACK TO SCHOOL GUIDE:

<https://online.flippingbook.com/view/525660565/>

ON-SITE COVID TESTING:

https://www.sandiegounified.org/covid-19_status/covid-19_testing

Parent Portal

*We are seeking
100% participating
in PowerSchool
Parent Portal.*

*If you need access,
please email
Shirley Lemmon at
slemmon@sandi.net*

Student Email Addresses

All student email addresses
(studentID@stu.sandi.net)
are active.

Teachers and staff will be
utilizing this tool to contact
students with important
information.

All students should plan on
checking their school email
at least twice a day to stay
on top of important
information being shared.

Mira Mesa High School
2021-2022 Marauder Minutes

<p>Regular Day ①</p> <table style="width: 100%; border-collapse: collapse;"> <tr><td style="width: 10%; text-align: right;">0</td><td style="width: 15%;">7:21</td><td style="width: 10%;">-</td><td style="width: 15%;">8:28 (67)</td></tr> <tr><td>1</td><td>8:35</td><td>-</td><td>9:31 (56)</td></tr> <tr><td>2</td><td>9:38</td><td>-</td><td>10:34 (56)</td></tr> <tr><td>3</td><td>10:41</td><td>-</td><td>11:37 (56)</td></tr> <tr><td>4</td><td>11:44</td><td>-</td><td>12:45 (61)</td></tr> <tr><td>Lunch</td><td>12:52</td><td>-</td><td>1:24 (32)</td></tr> <tr><td>5</td><td>1:31</td><td>-</td><td>2:27 (56)</td></tr> <tr><td>6</td><td>2:34</td><td>-</td><td>3:30 (56)</td></tr> <tr><td>7</td><td>3:37</td><td>-</td><td>4:33 (56)</td></tr> </table>	0	7:21	-	8:28 (67)	1	8:35	-	9:31 (56)	2	9:38	-	10:34 (56)	3	10:41	-	11:37 (56)	4	11:44	-	12:45 (61)	Lunch	12:52	-	1:24 (32)	5	1:31	-	2:27 (56)	6	2:34	-	3:30 (56)	7	3:37	-	4:33 (56)	<p>Modified Mondays (LATE START) ②</p> <table style="width: 100%; border-collapse: collapse;"> <tr><td colspan="4">Staff Development</td></tr> <tr><td style="width: 10%; text-align: right;">1</td><td style="width: 15%;">9:37</td><td style="width: 10%;">-</td><td style="width: 15%;">10:23 (46)</td></tr> <tr><td>2</td><td>10:30</td><td>-</td><td>11:16 (46)</td></tr> <tr><td>3</td><td>11:23</td><td>-</td><td>12:09 (46)</td></tr> <tr><td>4</td><td>12:16</td><td>-</td><td>1:07 (51)</td></tr> <tr><td>Lunch</td><td>1:14</td><td>-</td><td>1:44 (30)</td></tr> <tr><td>5</td><td>1:51</td><td>-</td><td>2:37 (46)</td></tr> <tr><td>6</td><td>2:44</td><td>-</td><td>3:30 (46)</td></tr> <tr><td>7</td><td>3:37</td><td>-</td><td>4:33 (56)</td></tr> </table> <p style="font-size: small;">9/27/21, 10/4/21, 10/11/21, 10/18/21, 10/25/21, 11/1/21, 11/8/21, 11/15/21, 11/29/21, 12/6/21, 12/13/21, 1/3/22, 1/10/22, 1/24/22, 1/31/22, 2/7/22, 2/14/22, 2/28/22, 3/7/22, 3/14/22, 3/21/22, 4/4/22, 4/11/22, 4/18/22, 4/25/22, 5/2/22, 5/9/22, 6/6/22</p>	Staff Development				1	9:37	-	10:23 (46)	2	10:30	-	11:16 (46)	3	11:23	-	12:09 (46)	4	12:16	-	1:07 (51)	Lunch	1:14	-	1:44 (30)	5	1:51	-	2:37 (46)	6	2:44	-	3:30 (46)	7	3:37	-	4:33 (56)
0	7:21	-	8:28 (67)																																																																						
1	8:35	-	9:31 (56)																																																																						
2	9:38	-	10:34 (56)																																																																						
3	10:41	-	11:37 (56)																																																																						
4	11:44	-	12:45 (61)																																																																						
Lunch	12:52	-	1:24 (32)																																																																						
5	1:31	-	2:27 (56)																																																																						
6	2:34	-	3:30 (56)																																																																						
7	3:37	-	4:33 (56)																																																																						
Staff Development																																																																									
1	9:37	-	10:23 (46)																																																																						
2	10:30	-	11:16 (46)																																																																						
3	11:23	-	12:09 (46)																																																																						
4	12:16	-	1:07 (51)																																																																						
Lunch	1:14	-	1:44 (30)																																																																						
5	1:51	-	2:37 (46)																																																																						
6	2:44	-	3:30 (46)																																																																						
7	3:37	-	4:33 (56)																																																																						

PSAT Minimum Day (LATE START)

Per	Time	Date
0	09:34 - 10:24 (50)	10/13
1	10:31 - 11:08 (37)	
2	11:15 - 11:52 (37)	
3	11:59 - 12:36 (37)	
4	12:43 - 1:25 (42)	
L	1:32 - 2:02 (30)	
5	2:09 - 2:46 (37)	
6	2:53 - 3:30 (37)	

③



SBAC & CAST Testing / TBD

Per	Time
1/6	8:35 - 9:31 (56)
2/5	9:38 - 10:34 (56)
3/4	10:41 - 11:37 (56)
L	11:44 - 12:16 (32)
4/3	12:23 - 1:24 (61)
5/2	1:31 - 2:27 (56)
6/1	2:34 - 3:30 (56)

④

Rally Dates

Per	Time	Dates
0	7:38 - 8:28 (50)	*Oct 15
1	8:35 - 9:20 (45)	TBD
2	9:27 - 10:12 (45)	
3	10:19 - 11:04 (45)	
4	11:11 - 11:56 (45)	
Rally	11:56 - 1:09 (73)	
Lunch	1:16 - 1:46 (30)	
5	1:53 - 2:38 (45)	
6	2:45 - 3:30 (45)	

⑥

Marauder Fair / May 26 ⑦

Per	Time
0	7:38 - 8:28 (50)
1	8:35 - 9:23 (48)
2	9:30 - 10:18 (48)
3	10:25 - 11:13 (48)
Break	11:20 - 11:30 (10)
4	11:37 - 12:25 (48)
5	12:32 - 1:20 (48)
6	1:27 - 2:15 (48)
Marauder Fair	2:15 - 3:30 (75)

Semester Final Exams - Minimum Day (EARLY RELEASE)

Day 1	Day 2	Day 3	Start	End
Per 1	3	5	8:35 - 10:41 (126)	
Lunch	Lunch	Lunch	10:48 - 11:19 (31)	
Per 2	4	6	11:26 - 1:32 (126)	

Semester 1 (1/19/22, 1/20/22, 1/21/22)
Semester 2 (6/10/22, 6/13/22, 6/14/22)

⑤

2021-2022 Holidays & Important Dates

August 30	Classes Begin
September 6	Labor Day
September 29	Fall Open House
October 15	Homecoming
November 11	Veteran's Day Observed
November 22-26	Thanksgiving Break
December 20 - December 31	Winter Break
January 17	Marlin Luther King Day
January 24	Second Semester Begins
February 18	Lincoln Day
February 21	Washington Day
March 28 - April 1	Spring Break
May 27	Non Instructional Day
May 30	Memorial Day Observed
June 14	Last Day of Student Attendance
June 14	Graduation

Grade Reports

Grade Period	Grades	Report
Ends (# wks)	Due	Distribution
(Fri)	(Tues)	(Thur)
Oct 8 (6)	Oct 12	Oct 14
Nov 19 (6)	Nov 30	Dec 2
Jan 21 (6)	Jan 25	Jan 27*
Mar 4 (6)	Mar 8	Mar 10
April 22 (6)	April 26	April 28
June 14 (7)	June 15	N/A*

* Semester report cards are printed by the district office and mailed to parent/guardian.

2021-2022 Meetings

ILT Meetings - 2nd Monday @8:28AM:
10/11/21, 11/8/21, 12/13/21, 1/10/22, 2/14/22, 3/14/22, 4/11/22, 5/9/22

Dept. Meetings - 3rd Monday @8:28AM:
10/18/21, 11/15/21, 1/24/22*, 2/28/22*, 3/21/22, 4/18/22, 5/16/22

SGT Meetings - 2nd Tuesday @ 3:35PM:
9/14/21, 10/12/21, 11/9/21, 12/14/21, 1/11/22, 2/8/22, 3/8/22, 4/12/22, 5/10/22

SSC Meetings - 2nd Wednesday @ 3:35PM:
9/8/21, 10/13/21, 11/10/21, 12/8/22, 1/12/22, 2/9/22, 3/9/22, 4/13/22, 5/11/22

*Moved due to holiday/off-calendar date.

Mira Mesa Blvd.
NORTH PARKING LOT

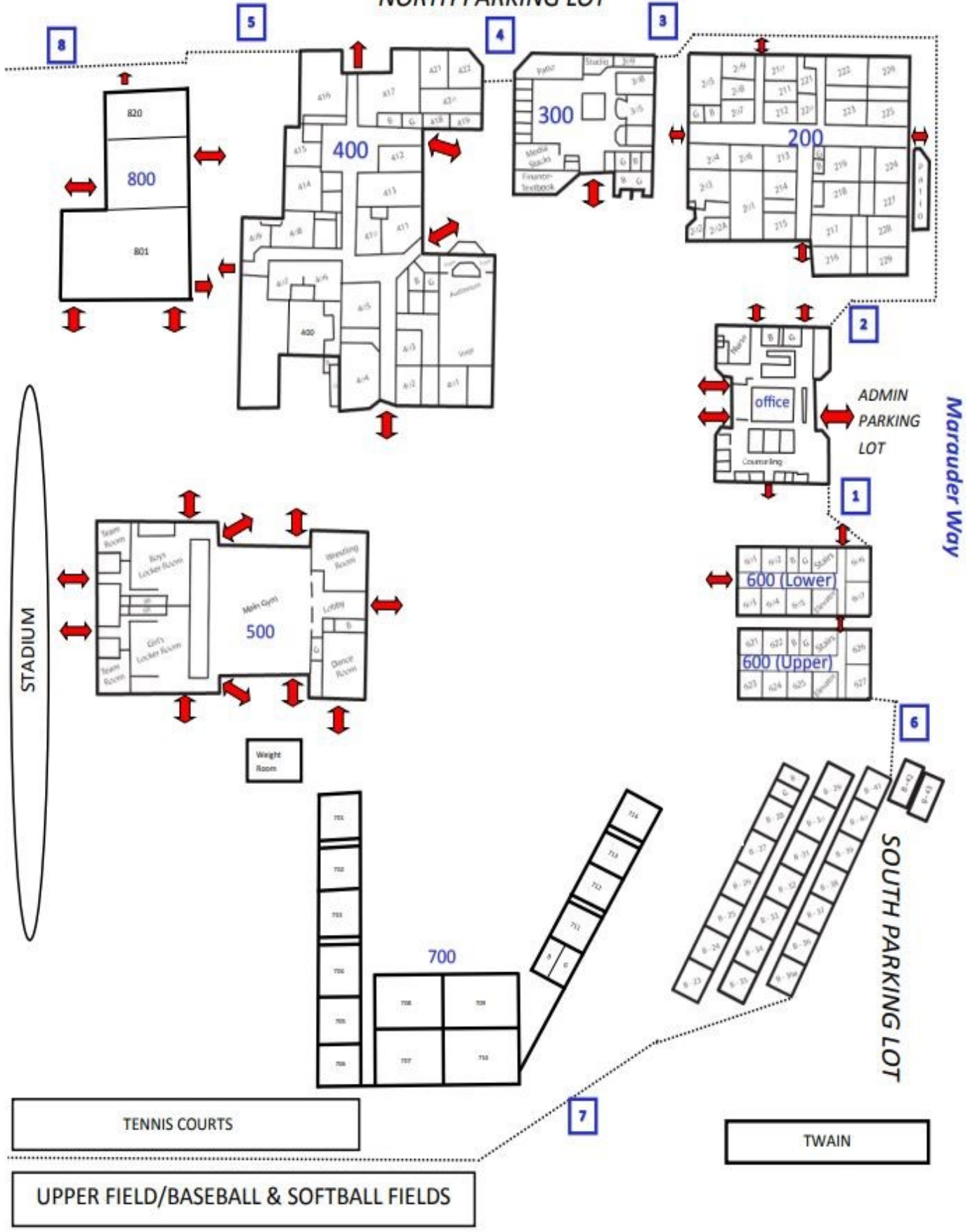

Marauder Way

SOUTH PARKING LOT

TENNIS COURTS

UPPER FIELD/BASEBALL & SOFTBALL FIELDS

TWAIN